

Mobile Sync for Webmail: Android

Please Note: Although Android runs on many different mobile devices, the set-up instructions remain pretty similar. Also, and before adding any sync service, you should consider backing up your existing data.

1. Click your phone's **Settings** icon, then find and click **Accounts & Sync**



2. Click the **New Account** or **Add Account** button



3. Select the **Corporate** or **MS Exchange** account. Note some devices only allow 1 of these accounts.



4. Enter your **Email Address** and **Email Password**. Then click **Next**.

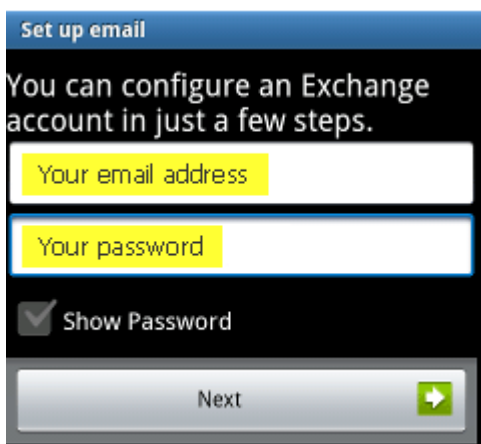

5. The following screen may differ considerably depending on your device. Remember to leave **Domain Blank** (the blank domain on left requires a slash \ before your email address). The **Server** value is **mobilesync.emailsrvr.com**

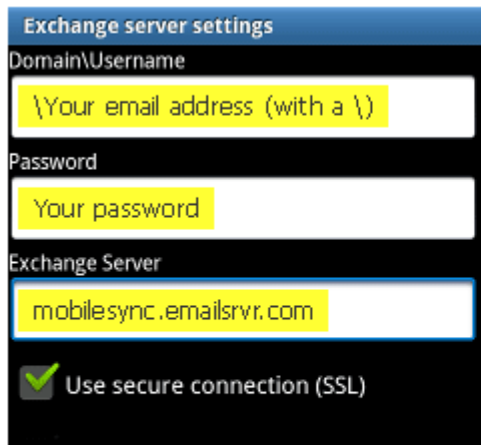

Exchange server settings

Domain\Username
Your email address (with a \)

Password
Your password

Exchange Server
mobilesync.emailsrvr.com

Use secure connection (SSL)

or

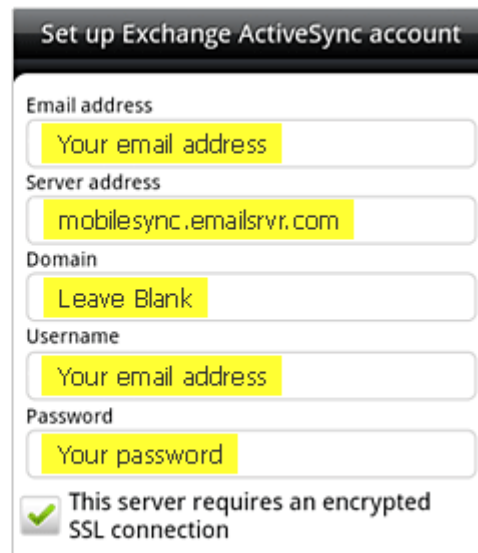

Set up Exchange ActiveSync account

Email address
Your email address

Server address
mobilesync.emailsrvr.com

Domain
Leave Blank

Username
Your email address

Password
Your password

This server requires an encrypted SSL connection

6. The next screen allows some account settings to be changed. These can also be changed later so if you're unsure just keep the default settings.

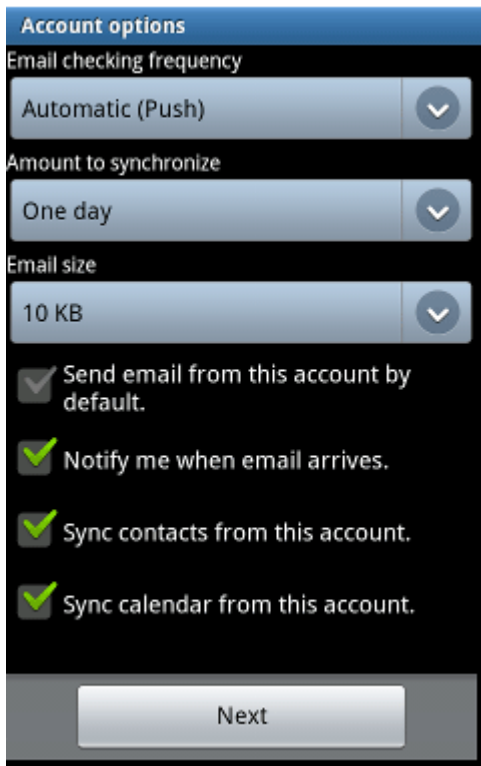

7. Finally, enter a name for the account and your display name and click **Done**.

